



# YOSHIMURA

RESEARCH&DEVELOPMENT OF AMERICA, INC.

5420 DANIELS STREET STE A, CHINO CALIF. 91710 · (800)634-9166 · (909)628-4722 · FACSIMILE (909)591-2198

[www.yoshimura-rd.com](http://www.yoshimura-rd.com)

## **Steering Stem Bolt** **090HA147000**

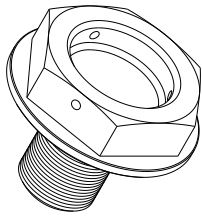

### **Instructions:**

1. Remove stock steering head bolt.
2. Install Yoshimura steering head bolt. Torque to factory specification.

If safety wire is required, loop safety wire through the holed drilled in the bolt and secure to stationary location on upper triple clamp.

Note: Installation to be performed by qualified technician only.

NO.	DESCRIPTION	QTY	PART #
1	Stem Bolt	1	090HA147000F



# YOSHIMURA

RESEARCH&DEVELOPMENT OF AMERICA, INC.

5420 DANIELS STREET STE A, CHINO CALIF. 91710 · (800)634-9166 · (909)628-4722 · FACSIMILE (909)591-2198

[www.yoshimura-rd.com](http://www.yoshimura-rd.com)

## **Steering Stem Bolt** **090HA147000**

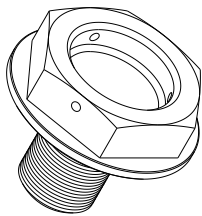

### **Instructions:**

1. Remove stock steering head bolt.
2. Install Yoshimura steering head bolt. Torque to factory specification.

If safety wire is required, loop safety wire through the holed drilled in the bolt and secure to stationary location on upper triple clamp.

Note: Installation to be performed by qualified technician only.

NO.	DESCRIPTION	QTY	PART #
1	Stem Bolt	1	090HA147000F